

# Peri-Operative Patient Care Breakthrough

## MobileSmith Health PeriOp: Connecting Care

As your health system gears up its surgery caseload to pre-COVID-19 levels and beyond, the challenges of managing patient throughput return with increased consumer expectations for efficiency forcing the need for better communication.

Epic partners with MobileSmith Health to improve Operating Room efficiency and performance. PeriOp accomplishes this by connecting providers to patients where they are – using a branded smartphone app – to guide them through pre-procedure preparation and post-op care.

Using PeriOp, clinicians assign a patient pathway with prebuilt procedure instructions to their patient directly from Epic’s patient record to begin real-time patient pathway tracking. The PeriOp adherence dashboard, embedded within Epic, provides an easy way for your care teams to understand if patients are staying on track preparing for procedures and identifying those that need additional assistance. Care team members can proactively intervene to reduce unnecessary cancellations. You can find the PeriOp solution in the [Epic App Orchard](#).



### **The MobileSmith Health EcoSystem**

#### **Understanding Our Integrated Health Vision**

Our mission is to transform healthcare by connecting patients to providers and improving overall experiences related to healthcare. We do this by developing solutions that remove barriers to providing high touch care adding very personal human experience. We enable patients to easily and effectively participate in their own care to move the needle on their health.

# Epic + MobileSmith Health Integration

## Clinical team works within their EMR - Epic

The MobileSmith Health Ecosystem supports EMR integration via SMART on FHIR integrations. We support multiple FHIR versions. This allows PeriOp to seamlessly interface with Epic patient information.

Assign directly from the Epic patient record

Surgery date and procedure info accessed by PeriOp

Pre-loaded, configured patient instruction pathways for specific procedures

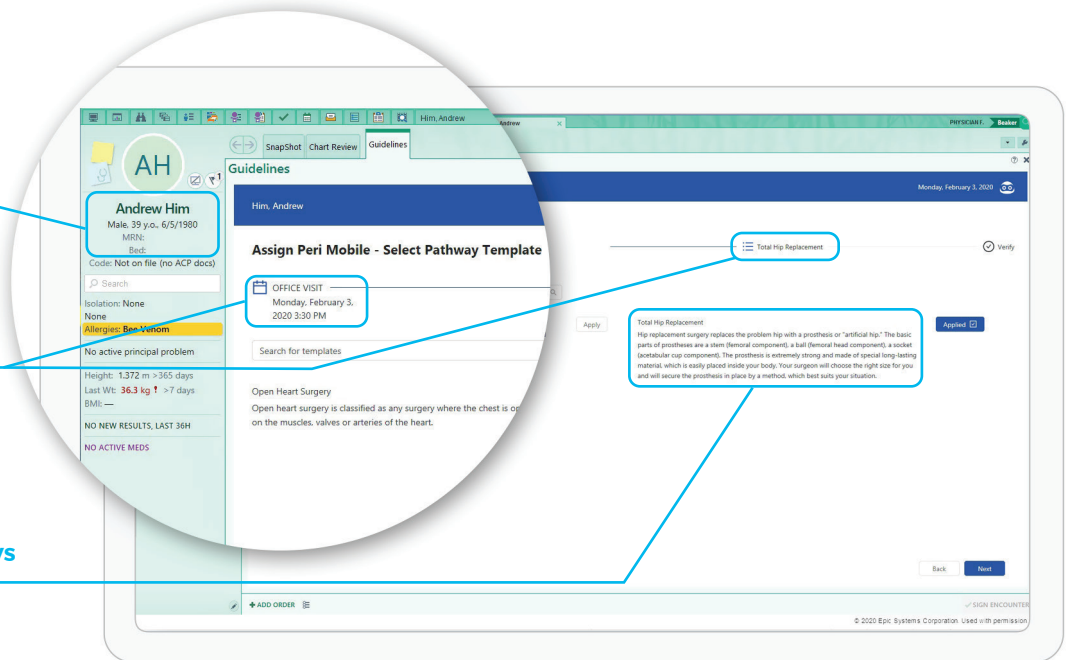

## FULLY EMBEDDED WORKFLOWS

### Bi-directional Data Information and Flow Integration

#### To MobileSmith Health

The first step in the MobileSmith PeriOp integrated workflow is to assign patients the PeriOp app. Clinicians initiate the integration behind the scenes by simply selecting the tab in their workflow. Behind the scenes they are properly authenticated using SMART on FHIR. This allows PeriOp to bring the patient demographic information (name, date, MRN and account number) into

the MobileSmith application back-end. Then patients can interact directly with the PeriOp app.

#### To Epic MyChart

MobileSmith PeriOp activates the PeriOp tab in Epic and provides a real-time patient adherence dashboard as patients complete their assigned tasks. From there, PeriOp updates the Primary Nurse Notes section within the patient record.



## Epic Partnership Program

MobileSmith Health's partnership with Epic, through the code program, enables access to custom FHIR APIs that can perform read and write services and allows for a seamless, end-to-end integration.



Contact MobileSmith Health today to set up your online demo for **PeriOp Patient Adherence!**

info@mobilesmith.com 855.516.2413 www.mobilesmith.com